



GARFIELD COUNTY TRAILS COMMITTEE PROJECT PROPOSAL FORM

Type of Project:

Trail Construction – New Trailhead Construction Trail Signage
 Trail Maps Trail Rehabilitation or Relocation Education Program
 Acquisition – easements, etc.

User(s) Served by Project:

ATV / OHV Hiker Biker Equestrian Other

Project Title: Dixie National Forest - Trailhead kiosks
 Project Sponsor: _____
 Location to nearest Town: Escalante, UT
 Project Manager: Jessica Grow
 Address: PO Box 246, Escalante, UT 84726
 Telephone: 435-826-5427 E-mail: jgrow@fs.fed.us

Please provide a brief description of the project along with its components (attach if additional space is needed):

\$2300.00 to purchase materials to build and install 5 trailhead information kiosks (see attached description and quote) Locations to be installed: Pine Lake OHV Trailhead, Antimony Creek, Pine Lake Day use area, East Boulder Creek Loop, Roger Peak TH, Island in the Sky TH
\$2500.00 to cover labor costs for a GS 5 for 120 hours and a GS 3 for 40 hours to construct and install 5 kiosks
\$2500.00 to purchase fiberglass panels for each trailhead kiosk that have a map and recreation information on them (See attached example)
\$1000.00 for 40 hours of a GS7 for the design of the kiosk map and recreation information for each kiosk

Amount of fiscal assistance requested:	<u>\$ 8,300.00</u>
Source of project funds	
Sponsor Cash	
Sponsor Labor and Equipment	<u>\$ 3,000.00</u>
Non-Sponsor donations*	
TOTAL PROJECT COST (total of above)	<u>\$ 11,300.00</u>

*Please list donors along with their contributions of cash, labor, materials, etc.:

Estimated annual maintenance cost: \$ 500.00

Who will provide the maintenance: Forest Service

Anticipated start date: 6/1/2010 Estimated completion date: 6/1/2011

Is public access guaranteed? Yes No

Project land owned or controlled by (check all that apply):
 City County State Federal Private

Will the project replace or enhance any existing recreation site or facility?

The kiosks will provide recreation information for hikers, bikers horseback riders and OHV riders at 5 trailheads

What recreational need will this project meet:

Providing recreation and safety information to the public

Is this project part of a long range plan and if so, please describe:

What support is there from the community, other user groups, institutions, etc.?

Certification:

I certify that I am authorized to sign this application and that the information herein provided is, to

Signature of Agent

Title

Date

Single Panel Kiosk Design

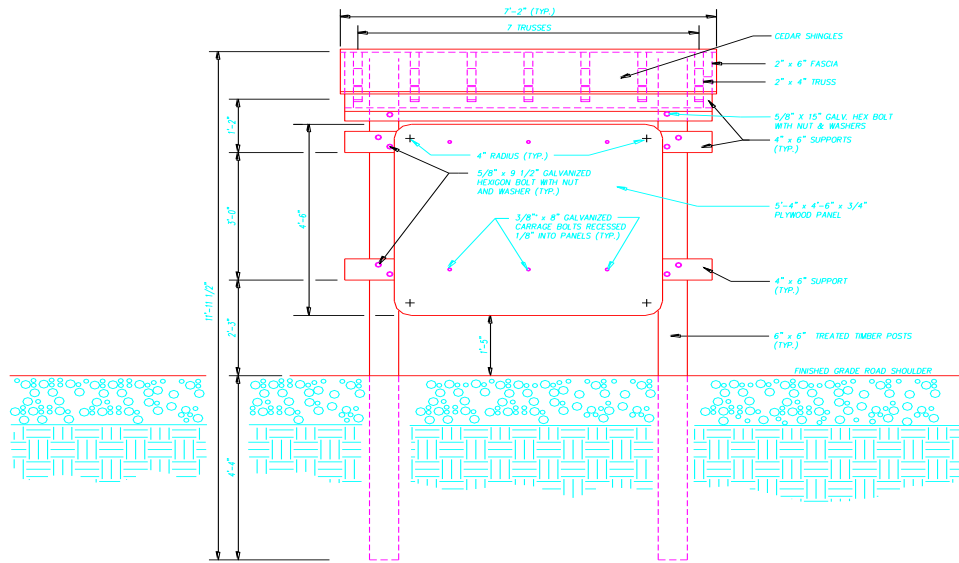

FRONT ELEVATION

NOTE:
SEE ITEM SPECIFICATION 11508.
FOR LUMBER SPECIFICATION.





Single Pannel Kiosk

Item	Quantity	Price ea	total
6X6X12 treated post	2	\$ 41.19	\$ 82.38
4X6X8 treated post	2	\$ 18.35	\$ 36.70
2X4X12	2	\$ 2.99	\$ 5.98
2X6X8 treated board	5	\$ 7.75	\$ 38.75
4X8X3/4 MDO 2-sided	1	\$ 56.15	\$ 56.15
Cedar shingles 1/2 square	2	\$ 46.30	\$ 92.60
5/8X 15" Galv hex bolt	4	\$ 10.70	\$ 42.80
5/8X 9 1/2 gal hex bolt	8	\$ 4.00	\$ 32.00
5/8 nut	12	\$ 0.38	\$ 4.56
5/8 washers	24	\$ 0.28	\$ 6.72
3/8X 8" Galv Carriage bolt	6	\$ 0.95	\$ 5.70
3/8 nuts	6	\$ 0.09	\$ 0.54
3/8 washers	6	\$ 0.07	\$ 0.42
2"X5" Galv anchor-plate	2		\$ -
4"X4" Galv anchor-plate "L"	6		\$ -
2 3/4" Outdoor HD Screws	1		\$ -
Ready-mix Cement 80 lbs bags	4	\$ 3.79	\$ 15.16

Cost/kiosk \$ 420.46

Boulder Swale ATV TRAILHEAD







RECREATION

The Boulder Swale ATV Trailhead is a great starting point for OHV riders, hikers, bikers and horseback riders. Access mountain lakes and scenic views via the many trails in the area including both the Motorized and Non-Motorized Great Western Trails.

OHV RIDERS - can ride the rocky Boulder Swale ATV 79, No. 022 and connect to the historical Great Western trail. Then take OHV access to McBeth Lake from the Boulder Swale ATV trail. To access McBeth Lake, only down FR 606 (the road you came in on) then turn right on FR 404. FR 404 ends at McBeth Lake.



BIKERS - A moderate-difficult loop ride can be made by taking the McBeth Section of the Great Western Trail No. 022 to McBeth Lake. Just beyond the dam turn left on FR 404. Turn left on FR 606 when you bring you back to the trailhead.



HIKERS - Hike to McBeth Lake via the McBeth Section of the Great Western Trail No. 022 for a nice day hike or combine other trails for a multi-day trip.



HORSEBACK RIDERS - The trails for bikers and hikers can make nice day rides. For longer rides try combining other trails for an out and back trip or a long loop.



USE RESTRICTIONS

To protect natural resources the following are PROHIBITED within the Dixie National Forest:

- Failing to dispose of all garbage (pack it out) or leaving human waste in an exposed or unsanitary manner (bury it).
- Damaging any natural feature. This includes, but is not limited to, felling or damaging trees, trenching, carving in rocks, and vandalism.
- Building any structure or improvement. This includes, but is not limited to, hitchhails, furniture, shelters, and dams.
- Driving motorized vehicles off designated roads and trails.

Please help us protect the Dixie National Forest . . . RESPECT RESTRICTIONS!

NOTICE - Violations are punishable by a maximum fine of \$5,000 and/or six months imprisonment (Title 18 USC 951). Other restrictions may apply. For more information, contact the Dixie National Forest.

LEAVE NO TRACE

- PLAN AHEAD AND PREPARE** - Know before you go! Learn everything you can about the area you plan to visit and the regulations for its use.
- TRAVEL AND CAMP ON DURABLE SURFACES** - Use established campsites and trails where available. Avoid sites just beginning to show impacts. Keep camps small and at least 200 feet from water, occupied campsites and trails if possible.
- DISPOSE OF WASTE PROPERLY** - Pack it in, pack it out! Bury human waste in a cathole 6-8 inches deep and 200 feet or as far as possible from water. Wash yourself and your dishes at least 200 feet from water. Carry out all trash and toilet paper.
- BE CONSIDERATE OF OTHER VISITORS** - Don't disturb others. Preserve the natural quiet.
- LEAVE WHAT YOU FIND** - Do not damage, deface, or remove natural objects or cultural artifacts. Leave them for others to enjoy. Don't build structures, dig trenches, or alter natural features.
- MINIMIZE USE AND IMPACTS OF FIRE** - Use a lightweight stove. Instead of a fire, if you build a fire, use only small dead wood found on the ground and use existing fire rings if possible.
- RESPECT WILDLIFE** - Watch wildlife from a distance and never approach, feed, or follow it. Seal food tightly and store it out of reach. Control pets at all times.

In case of an emergency call **911**

For recreation information call:
Escalante Interagency Visitor Center
(435) 826-9499

